

# Double Rail Type Hoist

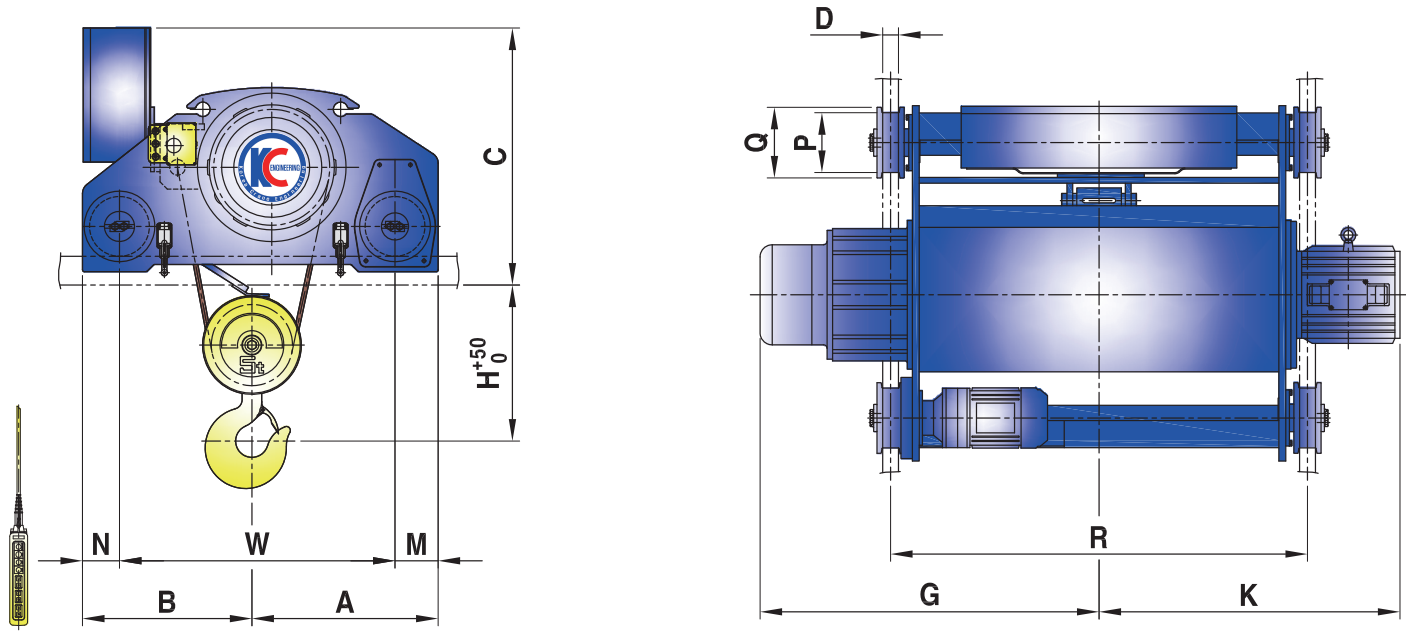

Capacity (ton)		2	3	5	7.5	10	15	20	
Model No.		D02-N-H12	D03-N-H12	D05-N-H12	D075-N-H12	D10-N-H12	D15-N-H12	D20-N-H12	
Hoisting	Lift Height (m)	12	12	12	12	12	12	12	
	Speed (m/min)	High 50/60 (Hz)	8.4/10	7.5/9	4.7/5.6	3.1/3.8	3.7/4.5	3.7/4.5	3.5/4.2
		Low 50/60 (Hz)	4.2/5	3.7/4.5	3.5/4.2	2.3/2.8	2.5/3	2.5/3	2.3/2.8
	Motor (kWxP)	High	3.7x4	5.5x4	5.5x6	5.5x6	9x8	13x8	17x8
		Low	1.8x8	2.8x8	4.2x8	4.2x8	6x12	8.5x12	11.5x12
Wire Rope [Φ x Falls]	Construction	6x37	6x37	6x37	6x37	6x37	6x37	6x37	
	Dia.(mm) x No. of ropes	8x4	9x4	12.5x4	14x4	16x4	20x4	22.4x4	
Brake		DC Magnet Disc Brake							
Traversing	Speed (m/min)	High 50/60 (Hz)	20/24	20/24	20/24	12.5/15	12.5/15	12.5/15	12.5/15
		Low 50/60 (Hz)	13/16	13/16	13/16	8.3/10	8.3/10	8.3/10	8.3/10
	Motor (kWxP)	High	0.75x4	0.75x4	0.75x4	0.75x4	0.75x4	1.5x4	1.5x4
		Low	0.5x6	0.5x6	0.5x6	0.5x6	0.5x6	1x6	
Dimension (approx.) (mm)	H	415	420	510	730	775	995	1175	
	R	950	950	1150	1150	1150	1200	1300	
	A	465	465	510	535	565	625	670	
	B	390	390	470	480	510	555	610	
	C	500	600	550	645	695	860	900	
	G	740	785	935	925	975	1075	1165	
	K	690	705	830	835	955	1005	1220	
	W	650	650	760	800	865	920	1000	
	D	47	47	58	58	58	58	58	
	M	115	115	125	120	120	130	140	
	N	90	90	110	95	100	130	140	
	P	140	140	165	165	165	180	220	
Q	170	170	190	195	195	210	250		
Weight (approx.) (kg)		450	550	850	900	1200	1820	2300	
Rail		15kg/m	15kg/m	15kg/m	15kg/m	15kg/m	22kg/m	22kg/m	

- All materials applied are suitable in specified ambient temperature.
- KCE Inc reserves the right to alter or amend the above information without notice.
- The size can be changed according to detailed design.

# Double Rail Type Hoist

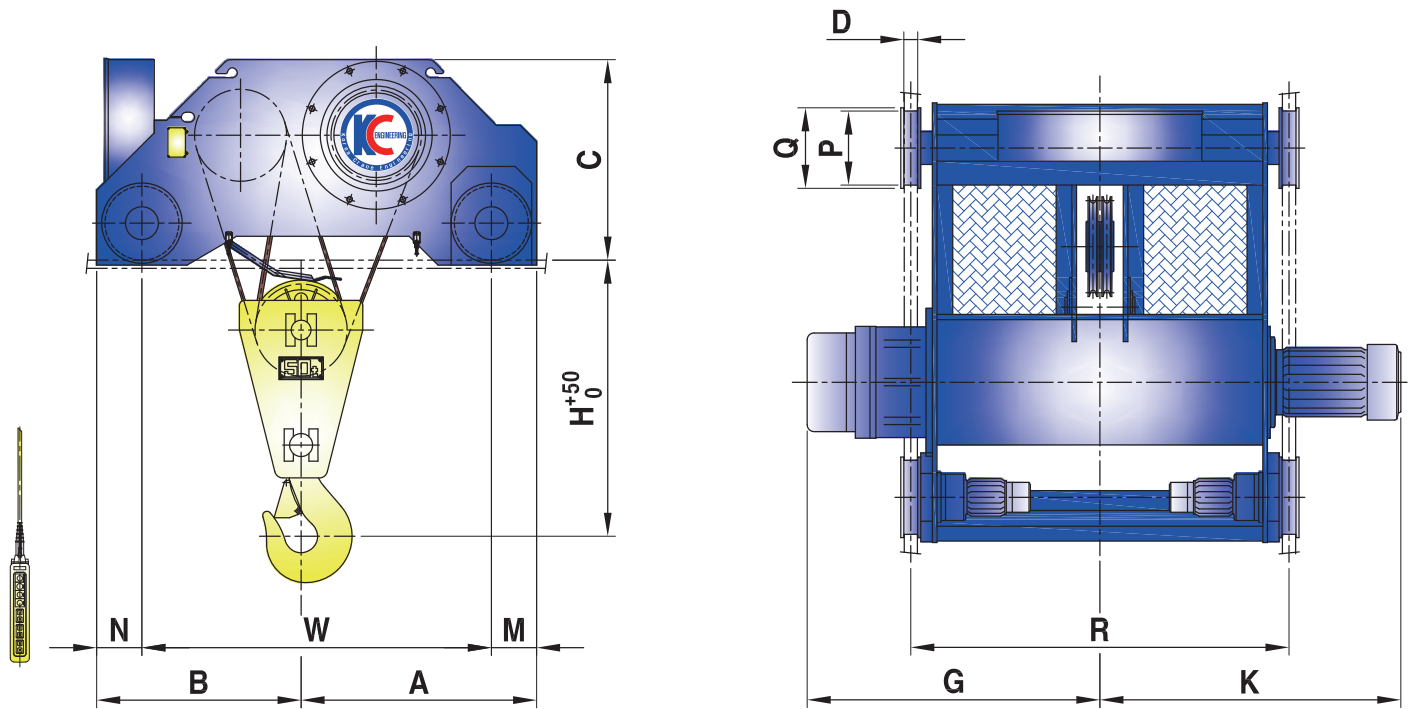

Capacity (ton)		30	35	40	50	60	70	
Model No.		D30-N-H12	D35-N-H12	D40-N-H12	D50-N-H12	D60-N-H12	D70-N-H12	
Hoisting	Lift Height (m)	12	12	12	12	12	12	
	Speed (m/min)	50 (Hz)	2.3	4	3.5	2.7	2	2
		60 (Hz)	2.8	4.8	4.2	3.2	2.4	2.4
	Motor (kWxP)	17x8	33x6	33x6	33x6	33x6	33x6	
	Wire Rope [Φ x Falls]	Construction	6x37	6xFi(25)	6xFi(25)	6xFi(25)	6xFi(25)	6xFi(25)
Dia.(mm) x No. of ropes		22.4x6	28x4	28x4	28x6	28x8	28x8	
Brake		DC Magnet Disc Brake						
Traversing	Speed (m/min)	High 50/60 (Hz)	12.5/15	12.5/15	12.5/15	12.5/15	12.5/15	
		Low 50/60 (Hz)	8.3/10	8.3/10	8.3/10	8.3/10	8.3/10	
	Motor (kWxP)	High	1.5x4 (2unit)	2.2x4	2.2x4	2.2x4 (2unit)	2.2x4 (2unit)	3.7x4 (2unit)
		Low	1x6 (2unit)	1.5x6	1.5x6	1.5x6 (2unit)	1.5x6 (2unit)	2.2x6 (2unit)
Dimension (approx.) (mm)	H	1480	1490	1490	1680	1780	1780	
	R	1800	1600	1600	2300	2800	2800	
	A	940	1025	1025	1432	1525	1525	
	B	940	955	955	1243	1150	1150	
	C	980	1013	1013	1220	1220	1220	
	G	1425	1455	1455	1780	2030	2030	
	K	1480	1360	1360	1715	1965	1965	
	W	1540	1550	1550	2125	2125	2125	
	D	70	70	70	80	80	80	
	M	180	215	215	275	275	300	
	N	160	215	215	275	275	300	
	P	250	355	355	450	450	500	
	Q	280	395	395	490	490	540	
Weight (approx.) (kg)		3450	5200	5200	7000	8500	9000	
Rail		30kg/m	37kg/m	37kg/m	73kg/m	73kg/m	73kg/m	

- All materials applied are suitable in specified ambient temperature.
- KCE Inc reserves the right to alter or amend the above information without notice.
- The size can be changed according to detailed design.