

Geared Motor

A-Type

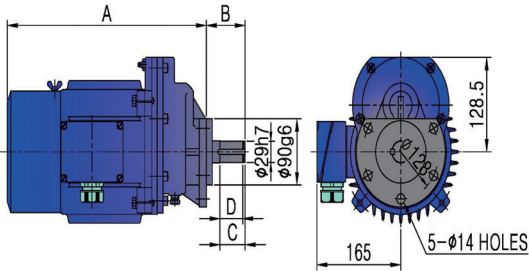

Dim. \ Cap.	0.5KW x 6P 0.75KW x 4P		1KW x 6P 1.5KW x 4P	
A	336		371	
B	56.5	77.5	87	
C	29	34	64	
D	25	30	60	
Reduce Ratio	1/8.4, 1/12.12, 1/16.36			

B-Type

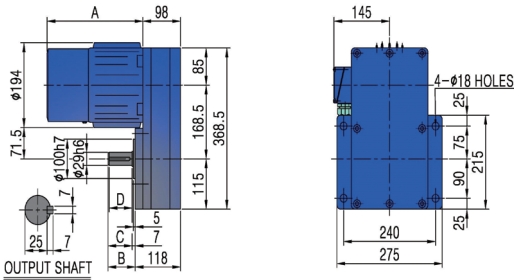

Dim. \ Cap.	0.5KW x 6P 0.75KW x 4P		1KW x 6P 1.5KW x 4P	
A	215		250	
B	71		71	
C	64		64	
D	60		60	
Reduce Ratio	1/12.4, 1/16.3, 1/22			

C-Type

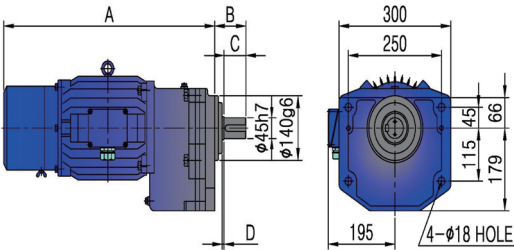

Dim. \ Cap.	1.5KW x 6P, 2.2KW x 4P	
A	565	
B	84	
C	59	
D	5	
Reduce Ratio	1/20.26	

D-Type

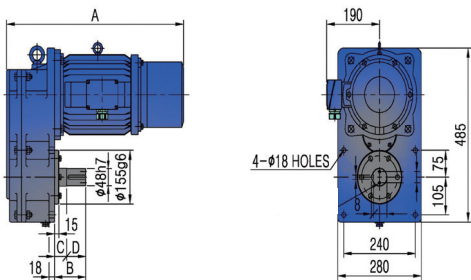

Dim. \ Cap.	2.2KW x 6P, 3.7KW x 4P 5.5KW x 4P	
A	592	
B	105	
C	41	
D	64	
Reduce Ratio	1/22	

E-Type

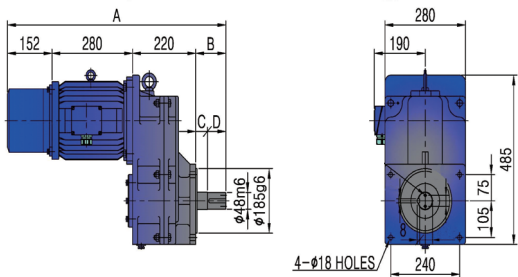

Dim. \ Cap.	2.2KW x 6P, 3.7KW x 4P 5.5KW x 4P	
A	757	
B	105	
C	41	
D	64	
Reduce Ratio	1/22	

Feature 1) Geared Motor with high standard Gear guarantees quiet operation and comfortable work environment.
2) The user can choose the single speed or the double speed according to purpose of usage.

Block Drive

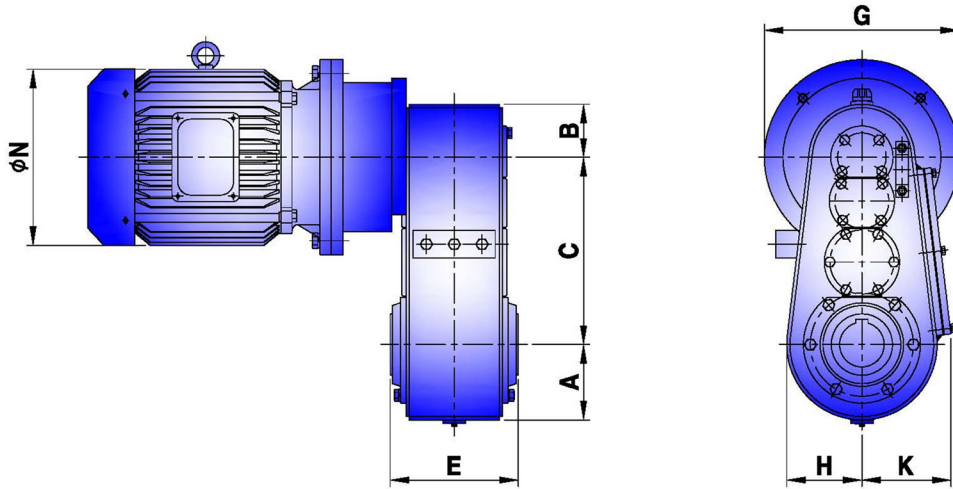

Model	Motor (kWxP)	Ratio	Output Torque (kg · m)	Application Wheel		Dimension (mm)								
				Dia(mm) & Load(kg)	Speed (m/min)	A	B	C	E	F	G	H	K	ϕN
KBM 08	3.7x6	1/63	250	$\phi 355$	20	170	120	336	230	530	300	135	165	266
	25300			30										
KBM 09	5.5x6	1/64	400	$\phi 450$	25	190	160	387	270	580	350	155	185	317
	32000			40										
KBM 10	7.5x6	1/62	600	$\phi 560$	33	220	185	454	350	680	350	185	215	317
	40000			50										
KBM 12	11x6	1/65	800	$\phi 710$	40	235	200	521	390	730	400	200	235	355
	50600			60										
KBM 14	15x6	1/80	1400	$\phi 900$	40	250	230	607	425	730	400	215	245	355
	64000			60										

Reducer Output Hollow Shaft

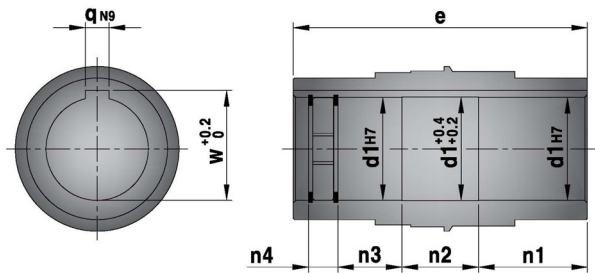

Wheel Solid Shaft

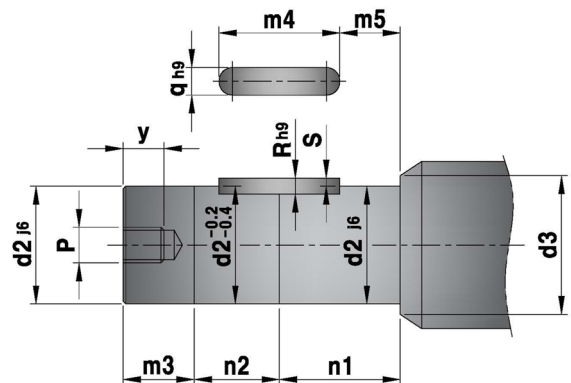

Model	Application Wheel							Dimension (mm)								
	n1	n2	n3	n4	d1	q	w	m3	m4	m5	f	s	d	d2	d3	y
KBM 08	85	60	50	23	80	22	85.4	45	160	35	14	5	M24	80	100	35
KBM 09	95	80	55	26	90	25	95.4	50	160	40	14	5	M24	90	110	35
KBM 10	105	140	56	35	105	28	114.4	50	200	45	16	6	M24	105	130	35
KBM 12	115	150	66	34	120	32	127.4	60	200	50	18	7	M24	120	150	35
KBM 14	135	155	77	36	140	36	148.4	70	240	55	20	8	M24	140	175	35

Note : Note : 1) Standard type : To attach DC Magnet Brake 2) To be possible to attach thruster brake. 3) Please make a contact about non-standard type.