

Hoisting Brake Ass'y

1TON

KEY NO.	PART NO.	PART NAME	Q'TY	REMARKS	KEY NO.	PART NO.	PART NAME	Q'TY	REMARKS
00	113 000	Brake Ass'y	1	1ton	17	113 010	Spacer Plate	1	
01	113 001	Brake Cover	1		18	014 156	Snap Ring	1	R47
02	022 162	Butterfly Bolt	3	M5x15L	19	113 052	Bearing	1	#6005DD
03	013 062	Safety Loop	1		20	113 011	Brake Spring	3	
04	013 053	Bolt	1	M6x35L	21	113 012	Guide Pin	3	
05	013 054	Spring Washer	1	M6	22	113 013	Motor Pinion	1	
06	013 055	Butterfly Nut	1	M6	23	113 053	Oil Seal	1	30428
07	013 002	Adjust Handle	1		24		Magnet Coil	6	
08	013 003	Adjust Bolt	1		25	113 014	Magnet Core	1	
09	013 056	Nut	6	M10	26	013 051	Bolt	6	M8x20L
10	014 052	Spring Washer	6	M10	27	013 052	Spring Washer	6	M8
11	113 004	Armature	1		28	113 054	O-Ring	1	3-Φ176
12	013 057	Stud Bolt	1	M6x20L	29	013 063	(+)Screw	2	M5x10L
13	113 005	Brake Disc "A"	1	With lining(1EA)	30	013 064	Spring Washer	2	M5
14	113 006	Brake Wheel	1		31	014 152	Nut	1	M5
15	113 007	Brake Lining	2						
16	113 009	Moving Core	1	With lining(1EA)					

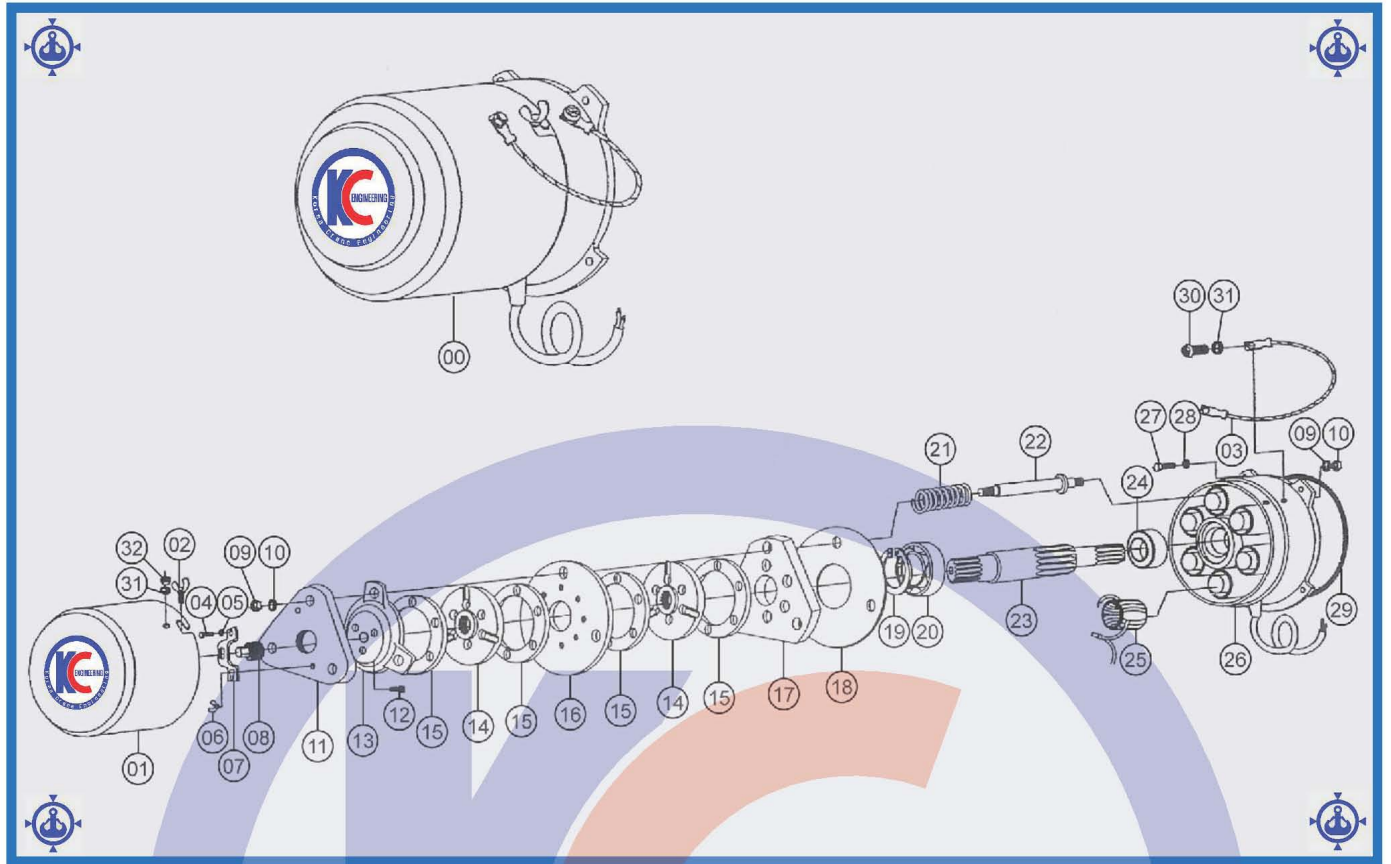

Hoisting Brake Ass'y

2TON

KEY NO.	PART NO.	PART NAME	Q'TY	REMARKS	KEY NO.	PART NO.	PART NAME	Q'TY	REMARKS
00	213 000	Brake Ass'y	1	2ton	17	213 009	Moving Core	1	With lining(1EA)
01	213 001	Brake Cover	1		18	213 010	Spacer Plate	1	
02	022 161	Butterfly Bolt	3	M5x15L	19	214 051	Snap Ring	1	R55
03	013 062	Safety Loop	1		20	113 052	Bearing	1	#6006DD
04	013 057	Bolt	1	M6x35L	21	213 011	Brake Spring	3	
05	013 054	Spring Washer	1	M6	22	213 012	Guide Pin	3	
06	013 055	Butterfly Nut	1	M6	23	213 013	Motor Pinion	1	
07	013 002	Adjust Handle	1		24		Magnet Coil	6	
08	013 003	Adjust Bolt	1		25	213 053	Oil Seal	1	35508
09	113 051	Nut	6	M10	26	213 014	Magnet Core	1	
10	014 157	Spring Washer	6	M10	27	016 051	Bolt	6	M8x20L
11	213 004	Armature	1		28	013 052	Spring Washer	6	M8x20L
12	013 057	Stud Bolt	1	M6x35L	29	213 054	O-Ring	1	3-Φ206
13	213 005	Brake Disc "A"	1	With lining(1EA)	30	013 063	(+)Screw	2	M5x10L
14	213 006	Brake Wheel	2		31	013 064	Spring Washer	2	M5
15	213 007	Brake Lining	4		32	014 152	Nut	1	M5
16	213 008	Brake Disc "B"	1	With lining(2EA)					

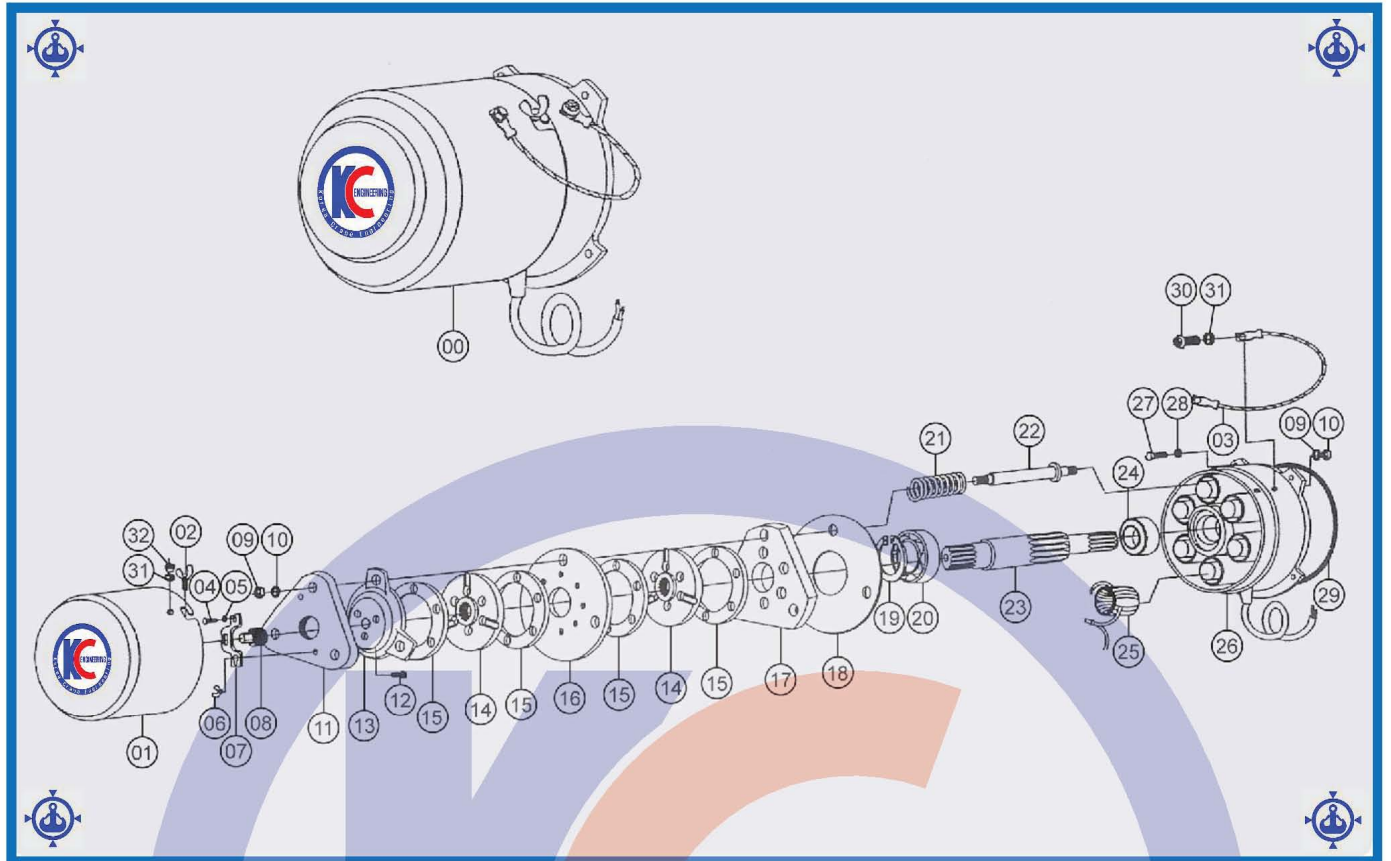

Hoisting Brake Ass'y

3TON

KEY NO.	PART NO.	PART NAME	Q'TY	REMARKS	KEY NO.	PART NO.	PART NAME	Q'TY	REMARKS
00	313 000	Brake Ass'y	1	3ton	17	313 009	Moving Core	1	With lining(1EA)
01	313 001	Brake Cover	1		18	313 010	Spacer Plate	1	
02	022 162	Butterfly Bolt	3	M5x15L	19	014 254	Snap Ring	1	R62
03	013 062	Safety Loop	1		20	313 051	Bearing	1	#6007DD
04	013 053	Bolt	1	M6x20L	21	313 011	Brake Spring	3	
05	013 054	Spring Washer	1	M6	22	313 012	Guide Pin	3	
06	131 158	Butterfly Nut	1	M6	23	313 013	Motor Pinion	1	
07	013 002	Adjust Handle	1		24	313 052	Oil Seal	1	40528
08	013 003	Adjust Bolt	1		25		Magnet Coil	6	
09	113 051	Nut	6	M10	26	313 014	Magnet Core	1	
10	014 157	Spring Washer	6	M10	27	014 158	Bolt	6	M10x35L
11	313 004	Armature	1		28	014 157	Spring Washer	6	M10
12	013 057	Stud Bolt	1	M6x35L	29	313 053	O-Ring	1	3-Φ246
13	313 005	Brake Disc "A"	1	With lining(1EA)	30	013 063	(+)Screw	2	M5x10L
14	313 006	Brake Wheel	2		31	013 064	Spring Washer	2	M5
15	313 007	Brake Lining	4		32	014 152	Nut	1	M5
16	313 008	Brake Disc "B"	1	With lining(2EA)					

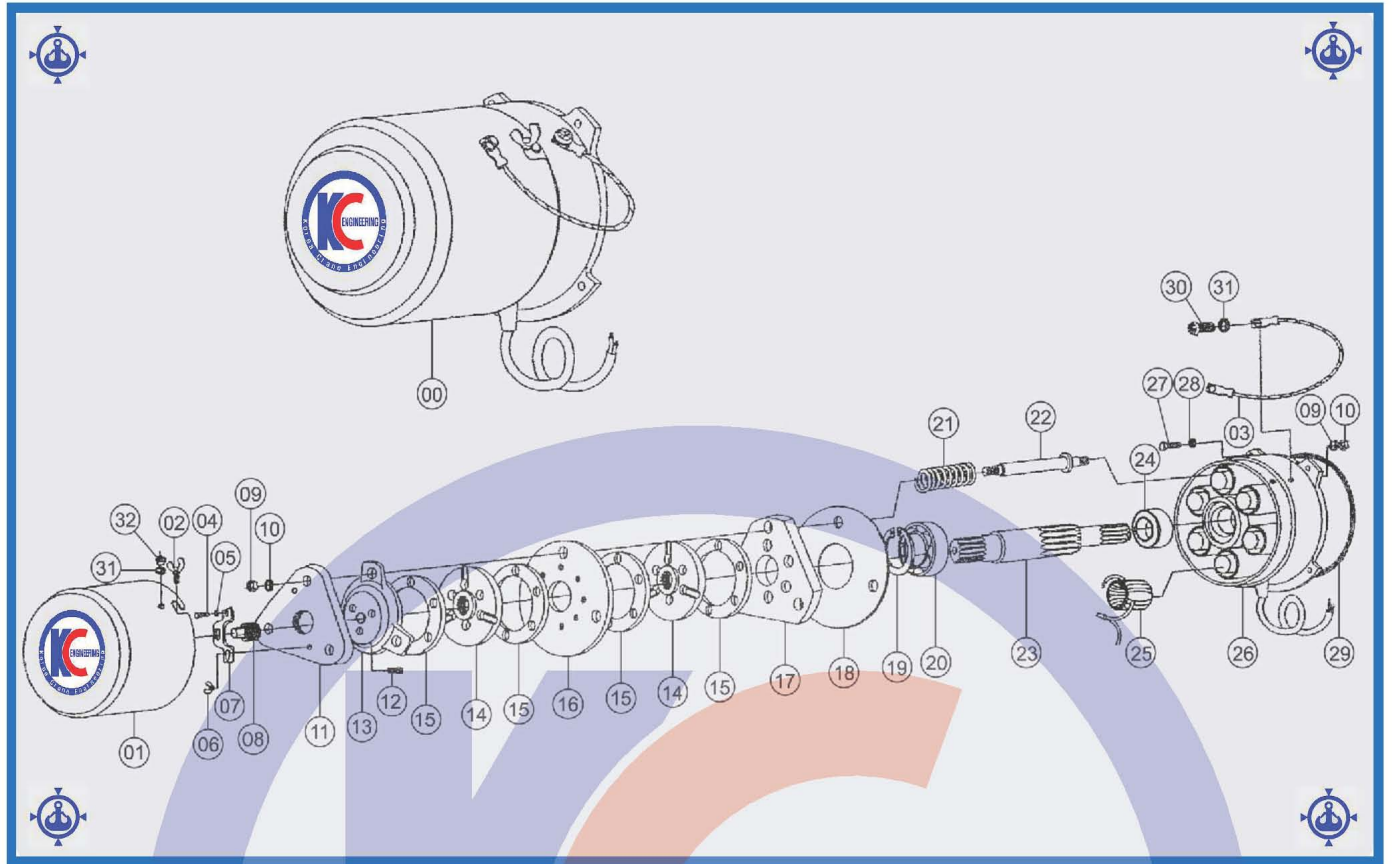

Hoisting Brake Ass'y

5TON

KEY NO.	PART NO.	PART NAME	Q'TY	REMARKS	KEY NO.	PART NO.	PART NAME	Q'TY	REMARKS
00	413 000	Brake Ass'y	1	5ton	17	413 009	Moving Core	1	With lining(1EA)
01	413 001	Brake Cover	1		18	413 010	Spacer Plate	1	
02	022 162	Butterfly Bolt	3	M5x15L	19	413 051	Snap Ring	1	R68
03	013 162	Safety Loop	1		20	413 052	Bearing	1	#6008DD
04	013 053	Bolt	1	M6x20L	21	413 011	Brake Spring	3	
05	013 054	Spring Washer	1	M6	22	413 012	Guide Pin	3	
06	013 055	Butterfly Nut	1	M6	23	413 013	Motor Pinion	1	
07	013 002	Adjust Handle	1		24	413 053	Oil Seal	1	45629
08	013 003	Adjust Bolt	1		25		Magnet Coil	6	
09	131 157	Nut	6	M12	26	413 014	Magnet Core	1	
10	011 051	Spring Washer	6	M12	27	016 156	Bolt	6	M10x30L
11	413 004	Armature	1		28	413 057	Spring Washer	6	M10
12	013 057	Stud Bolt	1	M6x35L	29	413 054	O-Ring	1	3-Φ300
13	413 005	Brake Disc "A"	1	With lining(1EA)	30	013 063	(+)Screw	2	M5x10L
14	413 006	Brake Wheel	2		31	013 064	Spring Washer	2	M5
15	413 007	Brake Lining	4		32	014 152	Nut	1	M5
16	413 008	Brake Disc "B"	1	With lining(2EA)					

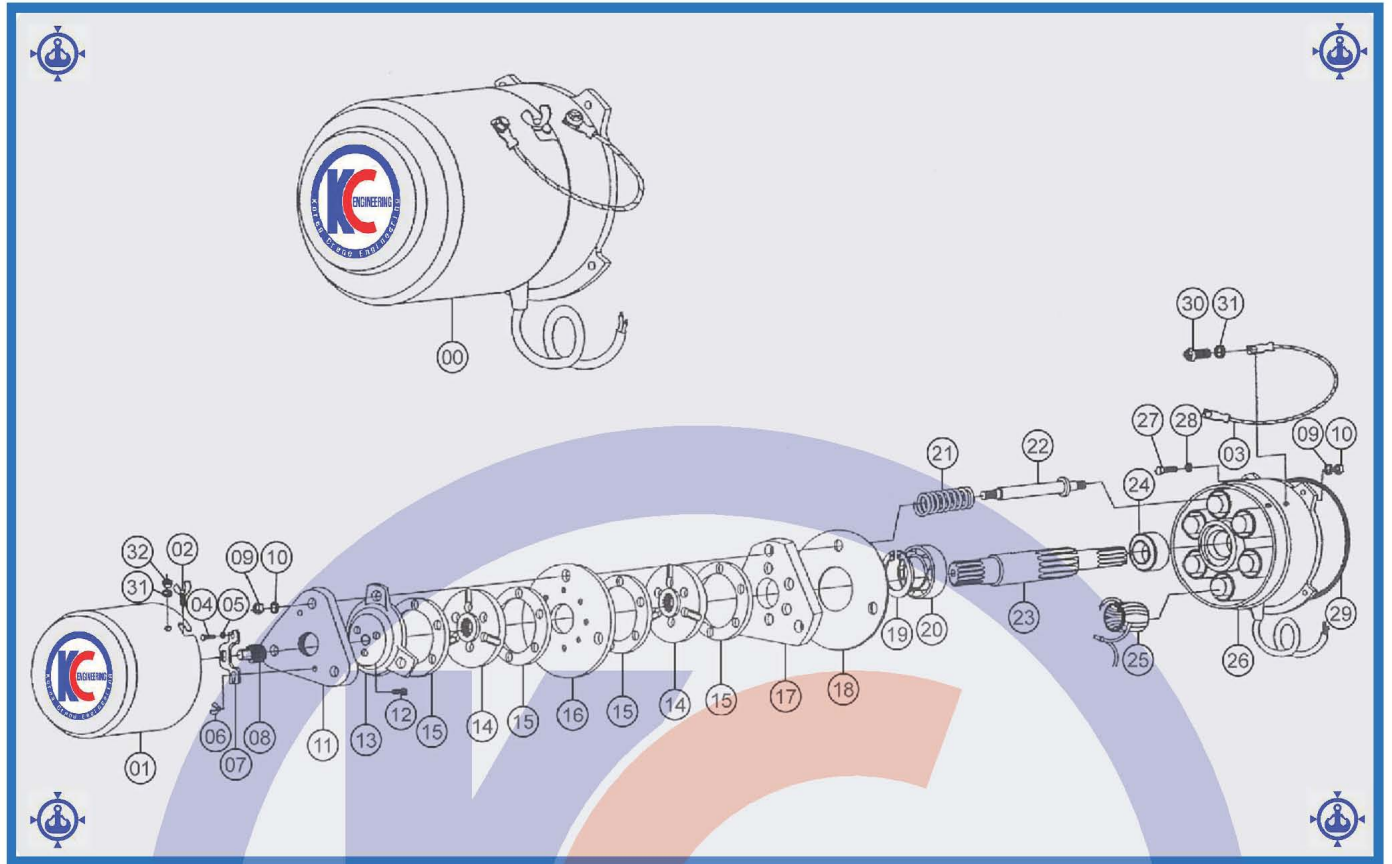

Hoisting Brake Ass'y

7.5TON

KEY NO.	PART NO.	PART NAME	Q'TY	REMARKS	KEY NO.	PART NO.	PART NAME	Q'TY	REMARKS
00	513 000	Brake Ass'y	1		17	413 009	Moving Core	1	With lining(1EA)
01	413 001	Brake Cover	1		18	413 010	Spacer Plate	1	
02	022 162	Butterfly Bolt	3	M5x15L	19	413 051	Snap Ring	1	R68
03	013 062	Safety Loop	1		20	413 052	Bearing	1	#6008DD
04	013 053	Bolt	1	M6x20L	21	513 011	Brake Spring	3	
05	013 054	Spring Washer	1	M6	22	413 012	Guide Pin	3	
06	013 055	Butterfly Nut	1	M6	23	413 013	Motor Pinion	1	
07	013 002	Adjust Handle	1		24	413 053	Oil Seal	1	45629
08	013 003	Adjust Bolt	1		25		Magnet Coil	6	
09	131 157	Nut	6	M12	26	513 014	Magnet Core	1	
10	011 051	Spring Washer	6	M12	27	016 056	Bolt	6	M10x30L
11	413 004	Armature	1		28	014 157	Spring Washer	6	M10
12	013 057	Stud Bolt	1	M6x35L	29	513 054	O-Ring	1	3-Φ340
13	413 005	Brake Disc "A"	1	With lining(1EA)	30	013 063	(+)Screw	2	M5x10L
14	413 006	Brake Wheel	2		31	013 064	Spring Washer	2	M5
15	413 007	Brake Lining	4		32	014 152	Nut	1	M5
16	413 008	Brake Disc "B"	1	With lining(2EA)					

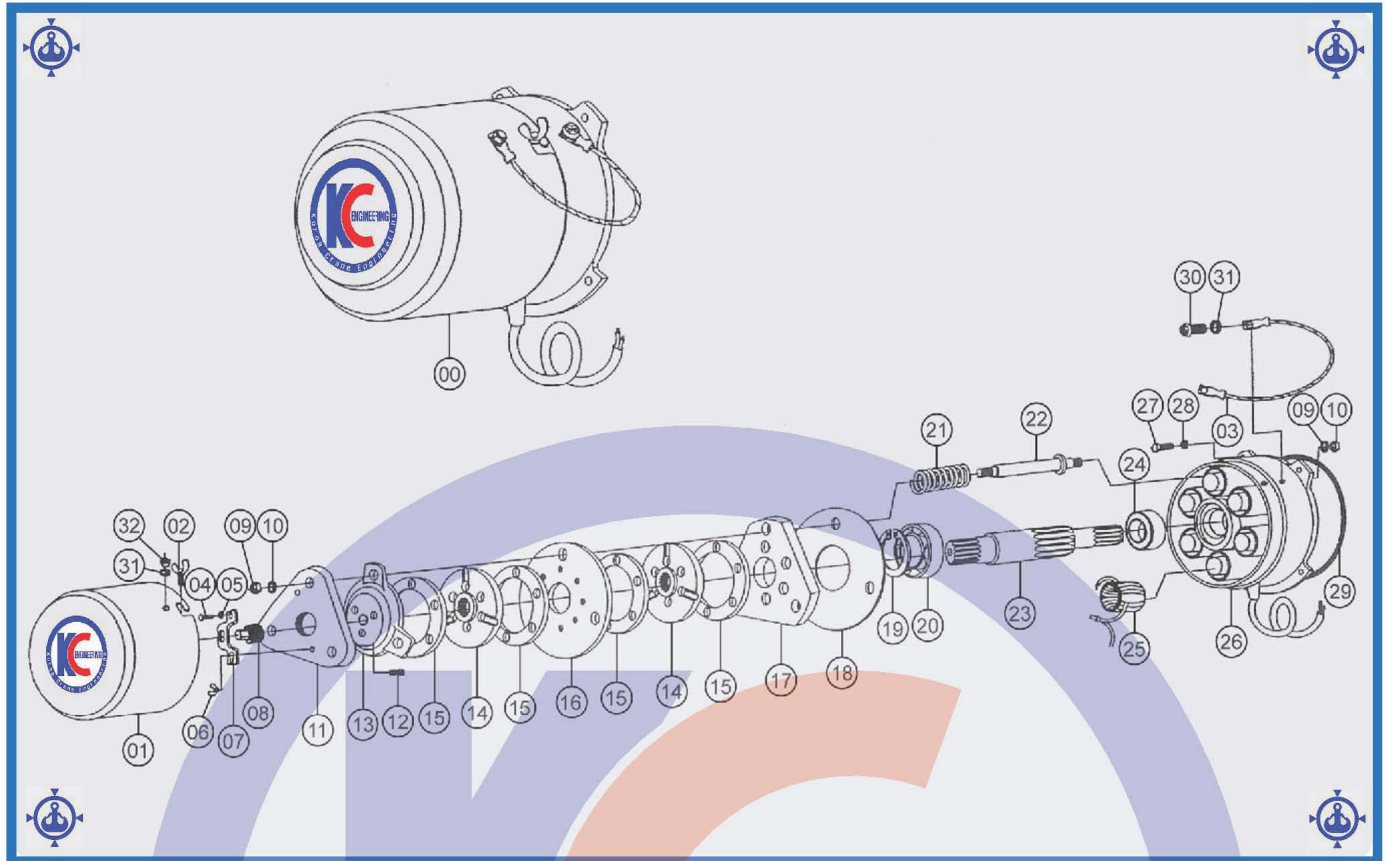

Hoisting Brake Ass'y

10TON

KEY NO.	PART NO.	PART NAME	Q'TY	REMARKS	KEY NO.	PART NO.	PART NAME	Q'TY	REMARKS
00	613 000	Brake Ass'y	1		17	413 009	Moving Core	1	With lining(1EA)
01	413 001	Brake Cover	1		18	413 010	Spacer Plate	1	
02	022 162	Butterfly Bolt	3	M5x15L	19	613 051	Snap Ring	1	R75
03	013 062	Safety Loop	1		20	613 052	Bearing	1	#6009DD
04	013 053	Bolt	1	M6x20L	21	613 011	Brake Spring	3	
05	013 054	Spring Washer	1	M6	22	613 012	Guide Pin	3	
06	013 055	Butterfly Nut	1	M6	23	613 013	Motor Pinion	1	
07	013 002	Adjust Handle	1		24	613 053	Oil Seal	1	55729
08	013 003	Adjust Bolt	1		25		Magnet Coil	6	
09	131 157	Nut	6	M12	26	613 014	Magnet Core	1	
10	011 051	Spring Washer	6	M12	27	016 056	Bolt	6	M10x30L
11	413 004	Armature	1		28	014 157	Spring Washer	6	M10
12	013 057	Stud Bolt	1	M6x35L	29	613 054	O-Ring	1	3-Φ360
13	413 005	Brake Disc "A"	1	With lining(1EA)	30	013 063	(+)Screw	2	M5x10L
14	613 006	Brake Wheel	2		31	013 064	Spring Washer	2	M5
15	413 007	Brake Lining	4		32	014 152	Nut	1	M5
16	413 008	Brake Disc "B"	1	With lining(2EA)					

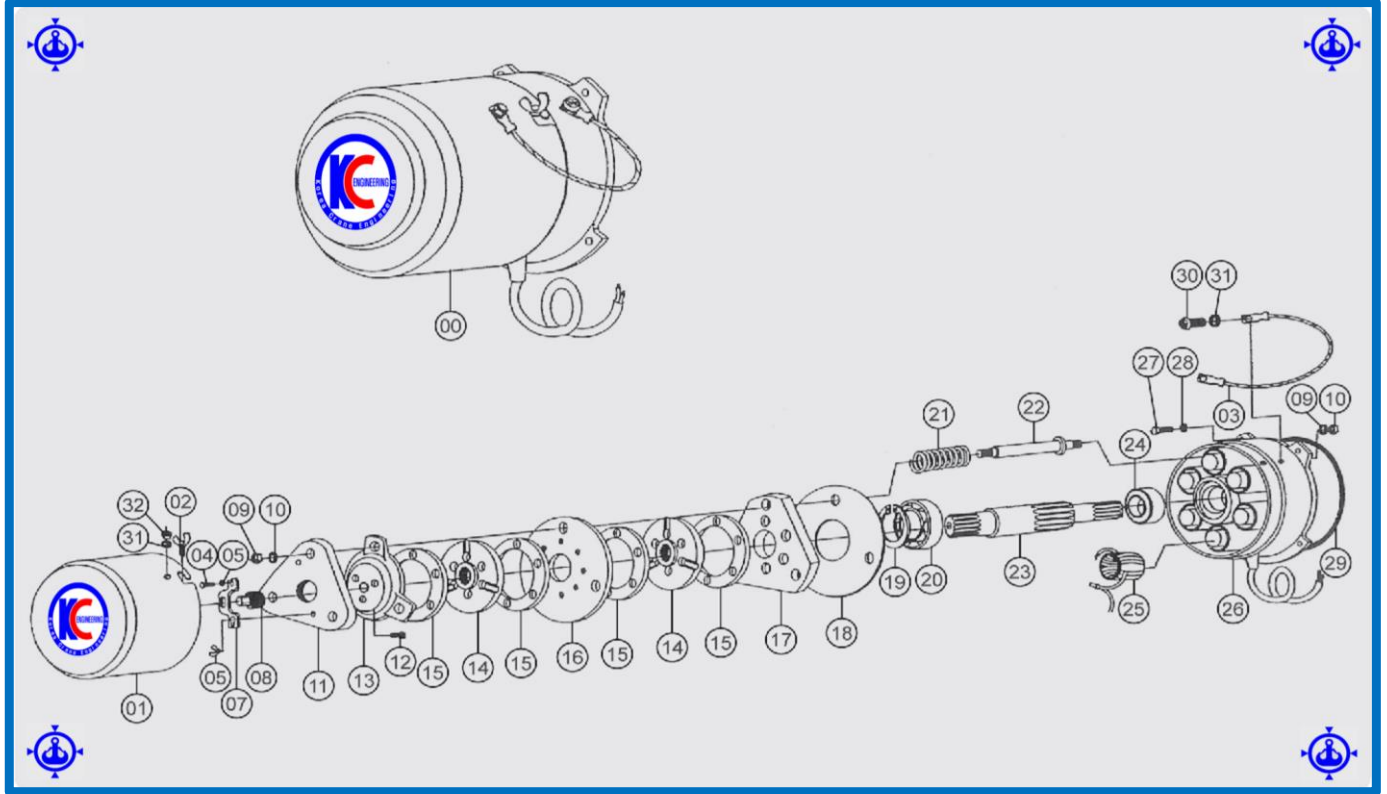

Hoisting Brake Ass'y

15TON

KEY NO.	PART NO.	PART NAME	Q'TY	REMARKS	KEY NO.	PART NO.	PART NAME	Q'TY	REMARKS
00	713 000	Brake Ass'y	1		17	713 009	Moving Core	1	With lining(1EA)
01	713 001	Brake Cover	1		18	713 010	Spacer Plate	1	
02	002 162	Butterfly Bolt	3	M5x15L	19	214 253	Snap Ring	1	R90
03	013 162	Safety Loop	1		20	713 052	Bearing	1	#6010DD
04	013 053	Bolt	1	M6x20L	21	713 011	Brake Spring	3	
05	013 054	Spring Washer	1	M6	22	713 012	Guide Pin	3	
06	013 055	Butterfly Nut	1	M5	23	713 013	Motor Pinion	1	
07	013 002	Adjust Handle	1		24	713 053	Oil Seal	1	608010
08	713 003	Adjust Bolt	1		25		Magnet Coil	6	
09	713 051	Nut	6	M16	26	713 014	Magnet Core	1	
10	211 051	Spring Washer	6	M16	27	416 051	Bolt	6	M12x45L
11	713 004	Armature	1		28	011 051	Spring Washer	6	M12
12	013 057	Stud Bolt	1	M6x35L	29	713 054	O-Ring	1	3-Φ440
13	713 005	Brake Disc "A"	1	With lining(1EA)	30	013 063	(+)Screw	2	M5x10L
14	713 006	Brake Wheel	2		31	013 064	Spring Washer	2	M5
15	713 007	Brake Lining	4		32	014 152	Nut	1	M5
16	713 008	Brake Disc "B"	1	With lining(2EA)					

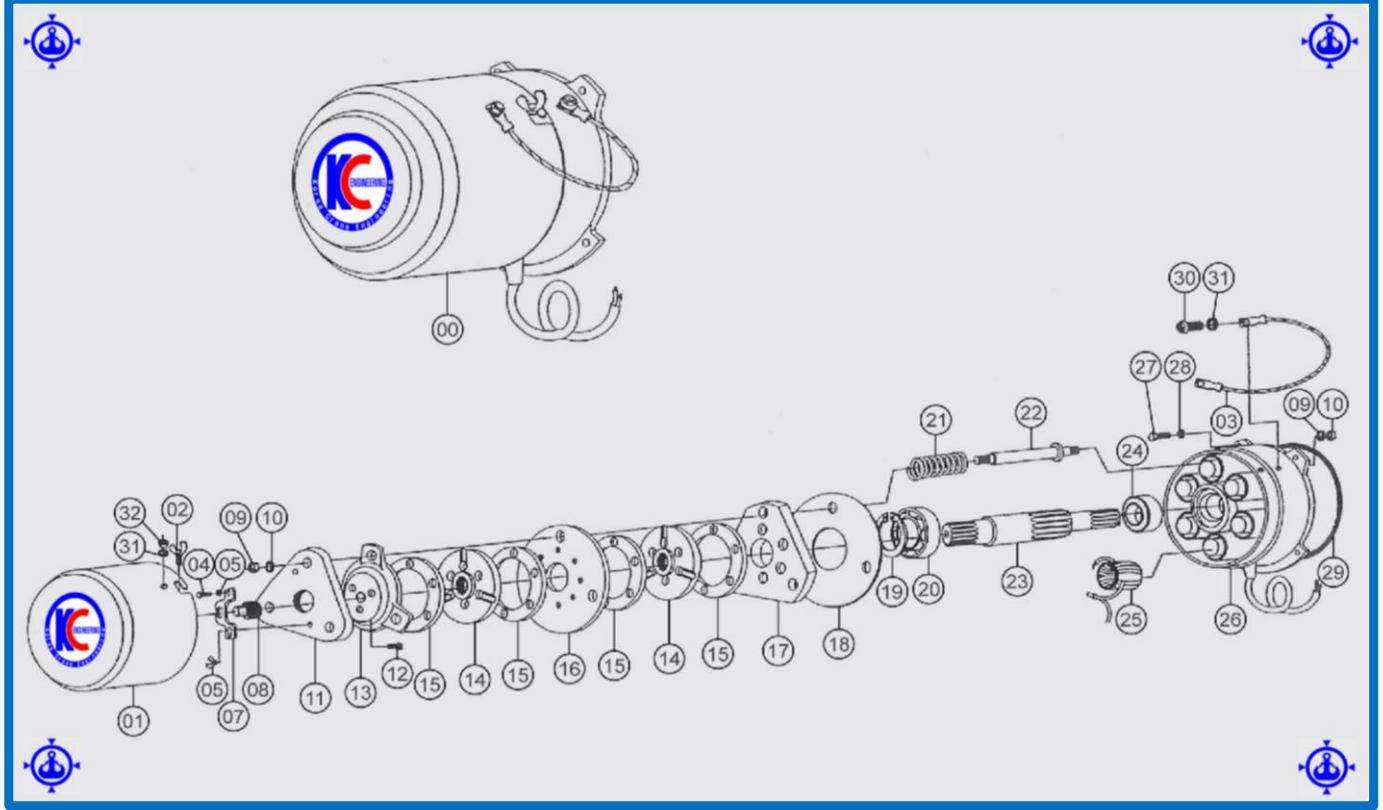

Hoisting Brake Ass'y

20TON

KEY NO.	PART NO.	PART NAME	Q'TY	REMARKS	KEY NO.	PART NO.	PART NAME	Q'TY	REMARKS
00	813 000	Brake Ass'y	1		17	713 009	Moving Core	1	With lining(1EA)
01	713 001	Brake Cover	1		18	713 010	Spacer Plate	1	
02	022 162	Butterfly Bolt	3	M5x15L	19	813 051	Snap Ring	1	R95
03	013 162	Safety Loop	1		20	731 252	Bearing	1	#6010DD
04	013 053	Bolt	1	M6x20L	21	813 011	Brake Spring	3	
05	013 054	Spring Washer	1	M6	22	813 012	Guide Pin	3	
06	013 055	Butterfly Nut	1	M5	23	813 013	Motor Pinion	1	
07	013 002	Adjust Handle	1		24	212 053	Oil Seal	1	709012
08	713 003	Adjust Bolt	1		25		Magnet Coil	6	
09	713 051	Nut	6	M16	26	813 014	Magnet Core	1	
10	211 051	Spring Washer	6	M16	27	416 051	Bolt	6	M12x45L
11	713 004	Armature	1		28	011 051	Spring Washer	6	M12
12	013 057	Stud Bolt	1	M6x35L	29	813 054	O-Ring	1	3-Φ495
13	713 005	Brake Disc "A"	1	With lining(1EA)	30	013 063	(+)Screw	2	M5x10L
14	713 006	Brake Wheel	2		31	013 064	Spring Washer	2	M5
15	713 007	Brake Lining	4		32	014 152	Nut	1	M5
16	713 008	Brake Disc "B"	1	With lining(2EA)					

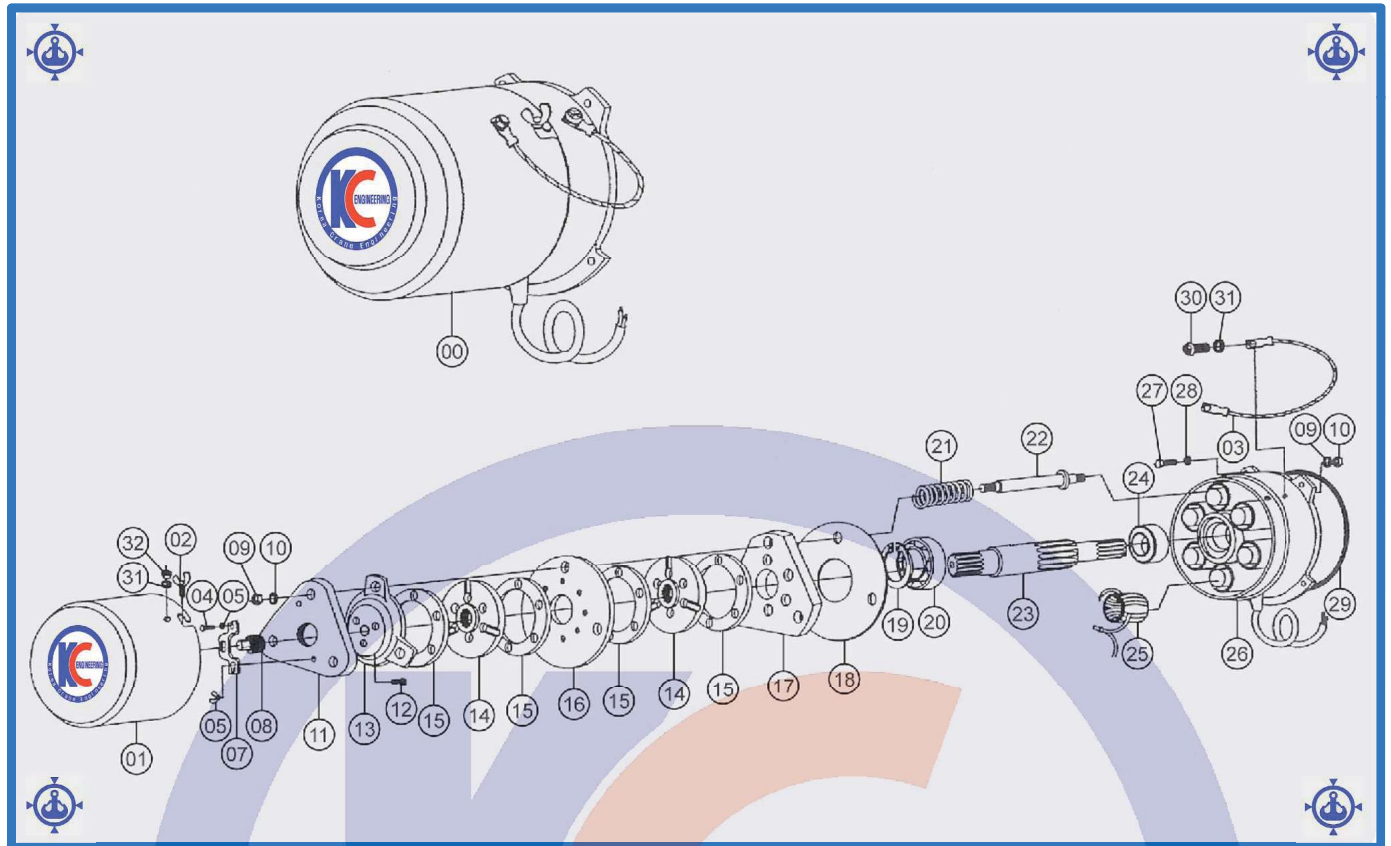

Hoisting Brake Ass'y

30TON

KEY NO.	PART NO.	PART NAME	Q'TY	REMARKS	KEY NO.	PART NO.	PART NAME	Q'TY	REMARKS
00	813 000	Brake Ass'y	1		17	713 009	Moving Core	1	With lining(1EA)
01	713 001	Brake Cover	1		18	713 010	Spacer Plate	1	
02	022 162	Butterfly Bolt	3	M5x15L	19	813 051	Snap Ring	1	R95
03	013 162	Safety Loop	1		20	731 252	Bearing	1	#6010DD
04	013 053	Bolt	1	M6x20L	21	813 011	Brake Spring	3	
05	013 054	Spring Washer	1	M6	22	813 012	Guide Pin	3	
06	013 055	Butterfly Nut	1	M5	23	813 013	Motor Pinion	1	
07	013 002	Adjust Handle	1		24	212 053	Oil Seal	1	709012
08	713 003	Adjust Bolt	1		25		Magnet Coil	6	
09	713 051	Nut	6	M16	26	813 014	Magnet Core	1	
10	211 051	Spring Washer	6	M16	27	416 051	Bolt	6	M12x45L
11	713 004	Armature	1		28	011 051	Spring Washer	6	M12
12	013 057	Stud Bolt	1	M6x35L	29	813 054	O-Ring	1	3-Φ495
13	713 005	Brake Disc "A"	1	With lining(1EA)	30	013 063	(+)Screw	2	M5x10L
14	713 006	Brake Wheel	2		31	013 064	Spring Washer	2	M5
15	713 007	Brake Lining	4		32	014 152	Nut	1	M5
16	713 008	Brake Disc "B"	1	With lining(2EA)					

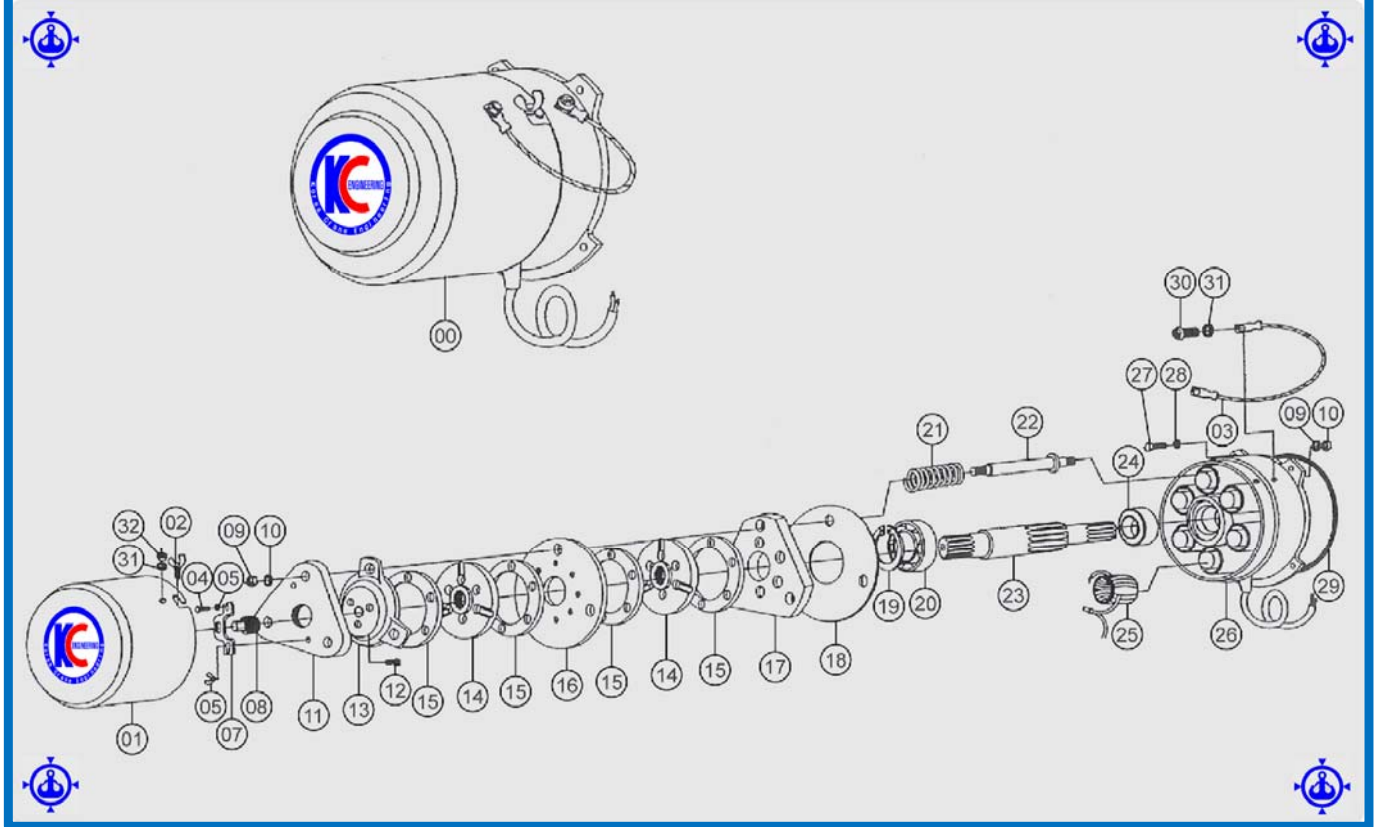

Hoisting Brake Ass'y

40TON

KEY NO.	PART NO.	PART NAME	Q'TY	REMARKS	KEY NO.	PART NO.	PART NAME	Q'TY	REMARKS
00	813 000	Brake Ass'y	1		17	713 009	Moving Core	1	With lining(1EA)
01	713 001	Brake Cover	1		18	713 010	Spacer Plate	1	
02	022 162	Butterfly Bolt	3	M5x15L	19	813 051	Snap Ring	1	R95
03	013 162	Safety Loop	1		20	731 252	Bearing	1	#6010DD
04	013 053	Bolt	1	M6x20L	21	813 011	Brake Spring	3	
05	013 054	Spring Washer	1	M6	22	813 012	Guide Pin	3	
06	013 055	Butterfly Nut	1	M5	23	813 013	Motor Pinion	1	
07	013 002	Adjust Handle	1		24	212 053	Oil Seal	1	709012
08	713 003	Adjust Bolt	1		25		Magnet Coil	6	
09	713 051	Nut	6	M16	26	813 014	Magnet Core	1	
10	211 051	Spring Washer	6	M16	27	416 051	Bolt	6	M12x45L
11	713 004	Armature	1		28	011 051	Spring Washer	6	M12
12	013 057	Stud Bolt	1	M6x35L	29	813 054	O-Ring	1	3-Φ495
13	713 005	Brake Disc "A"	1	With lining(1EA)	30	013 063	(+)Screw	2	M5x10L
14	713 006	Brake Wheel	2		31	013 064	Spring Washer	2	M5
15	713 007	Brake Lining	4		32	014 152	Nut	1	M5
16	713 008	Brake Disc "B"	1	With lining(2EA)					